



Winnepeg 2

4 2 2 2

Features

- 4 Bedrooms with B.I.R's
- Ensuite to Master Bedroom with W.I.R
- Open plan Family / Dining / Kitchen
- Separate Living area
- Covered outdoor entertaining area
- Modern and stylish facade
- Modern Kitchen with Breakfast Bar
- Double lock-up garage with internal entry
- Built-in Laundry
- Ceiling fans throughout

Dimensions

Total Area	194.52 sqm
Total Squares	20.94 sq
House Width	10.37 m
House Length	24.09 m

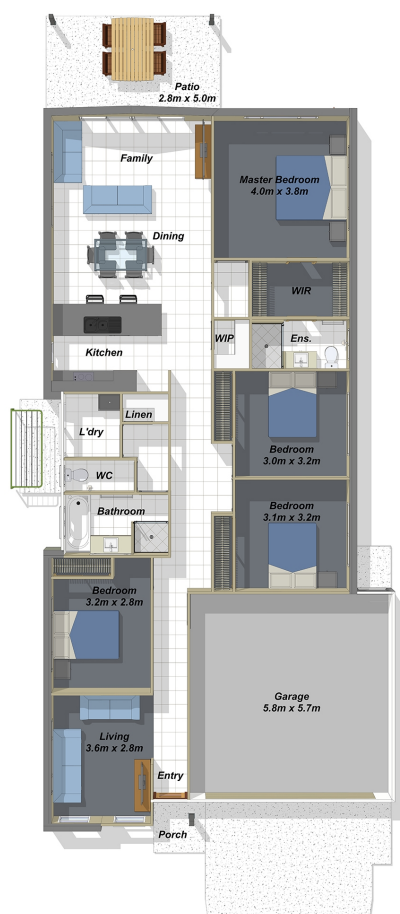

Note: If image shows Colorbond roof and render this is extra from standard. External lights are non-standard. House illustration is an artist impression only. House size is only a guide, measurements may differ in actuality.

